

15, Glendower Court, Greenfields, Shrewsbury, SY1 2RG
£750 Per Month



15, Glendower Court, Greenfields, Shrewsbury, SY1 2RG

£750 Per Month

VIRTUAL TOUR AVAILABLE - Modern two bedroom terraced house in cul de sac position in the popular residential area of Greenfields. Includes parking space.

Available: 17/05/25

Description

Comprising: Entrance lobby, living room with dining area and patio doors to rear, new kitchen including oven and hob. Stairs to first floor landing, master bedroom including airing cupboard, further bedroom, new bathroom including shower. Gas central heating, double glazing. Easy maintenance rear garden. Parking to side. EPC C.



Unfurnished

Council Tax Band: B

Available: 17th May 2025

EPC: C

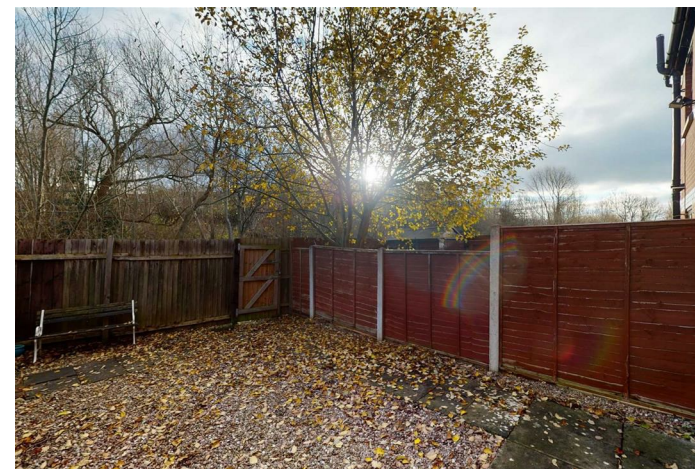

Floor Plans

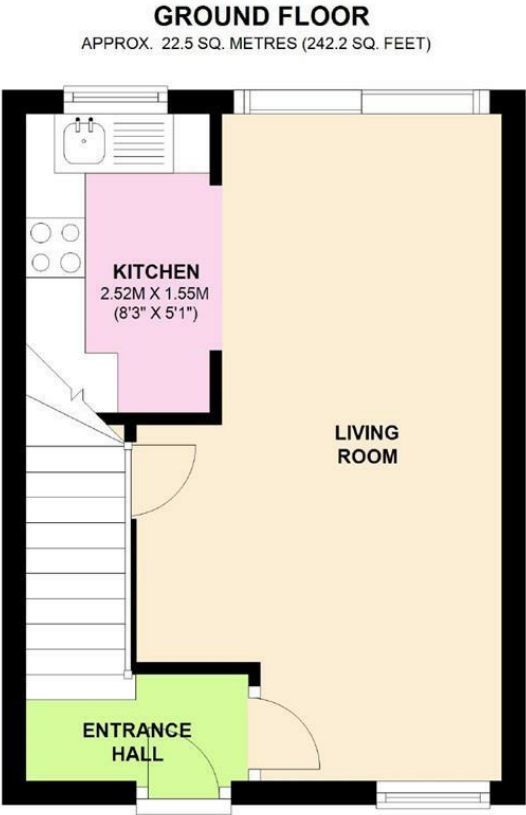

TOTAL AREA: APPROX. 45.0 SQ. METRES (484.2 SQ. FEET)

We accept no responsibility for any mistake or inaccuracy contained within the floorplan. The floorplan is provided as a guide only and should be taken as an illustration only. The measurements, contents and positioning are approximations only and provided as a guidance tool and not an exact replication of the property.
Plan produced using PlanUp.

These particulars, whilst believed to be accurate are set out as a general outline only for guidance and do not constitute any part of an offer or contract. Intending purchasers should not rely on them as statements of representation of fact, but must satisfy themselves by inspection or otherwise as to their accuracy. No person in this firms employment has the authority to make or give any representation or warranty in respect of the property.